

Instruction Manual | Bedienungsanleitung | Manual de instrucciones | Manuale d'istruzioni | Manuel d'instructions |
 Handleiding | Návod k použití

A1
2 pcs

A2
4 pcs

A3
4 pcs

A4
2 pcs

	X(mm)	Y(mm)
600mm	50	350
1200mm	50	825
1500mm	50	940
1800mm	50	687+687

35±1mm
30±1mm
8±1mm

N
L
PE

2x
"click"

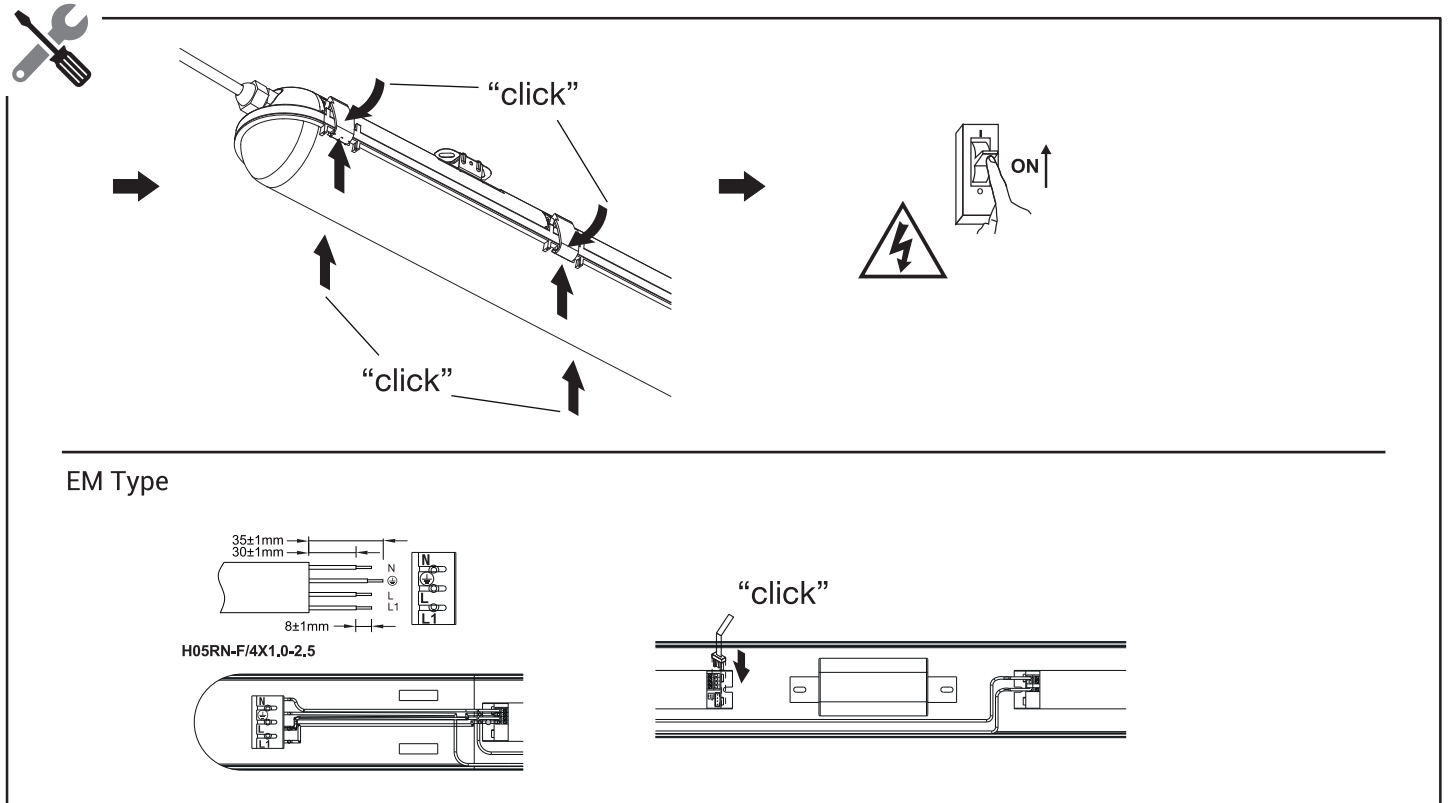

EM Type

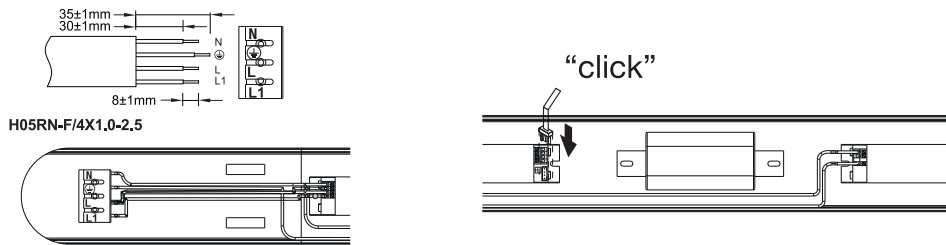

CAUTIONS:

Water resistant might decrease if there are any improper drill to the body of this luminaire housing. Always use the provided mounting brackets or suspension loops.

The light source contained in this luminaire shall only be replaced by the manufacturer or his service agent or a similar qualified person.
 Das in dieser Leuchte enthaltene Leuchtmittel darf nur durch den Hersteller, seinen Kundendienst oder entsprechend qualifiziertes Fachpersonal ausgetauscht werden.
 La fuente de iluminación de esta luminaria solo debe ser sustituida por el fabricante o su agente de servicio, o en su caso, por personal cualificado.
 La sorgente luminosa contenuta in questo apparecchio deve essere sostituita esclusivamente dal produttore, dal suo rappresentante o da una persona similmente qualificata.
 La source lumineuse contenue dans ce luminaire ne doit être remplacée que par le fabricant ou son agent de maintenance ou une personne de qualification équivalente.
 De lichtbron in deze lamp mag alleen worden vervangen door de fabrikant, zijn serviceagent of een vergelijkbaar gekwalificeerd persoon.
 Zdroj světla v tomto svítidle smí být vyměněn pouze elektrikářem, nebo servisním agentem výrobce.

	P	I	Ta	W	
FOB75700v0	20W	97mA	-30°C~ +50°C	1430g	1193
FOB75700v0-em	22W	106mA	-10°C~ +50°C	1780g	1193
FOB75700v1	40W	193mA	-30°C~ +50°C	1460g	1193
FOB75700v1-em	42W	203mA	-10°C~ +50°C	1810g	1193
FOB75800v0	30W	145mA	-30°C~ +50°C	1750g	1493
FOB75800v0-em	32W	155mA	-10°C~ +50°C	2160g	1493
FOB75800v1	60W	290mA	-30°C~ +50°C	1810g	1493
FOB75800v1-em	64W	309mA	-10°C~ +50°C	2430g	1493
FOB75900v0	40W	193mA	-30°C~ +50°C	2270g	1793
FOB75900v0-em	42W	203mA	-10°C~ +50°C	2640g	1793
FOB75900v1	80W	386mA	-30°C~ +50°C	2330g	1793
FOB75900v1-em	84W	406mA	-10°C~ +50°C	2950g	1793

220-240V~

50/60 Hz

$\lambda > 0.9$

IP65 IK10

